

# Montana Parts List

PART	DESCRIPTION	QTY
A	DOOR STILE	2
B	TOP/BOTTOM DOOR RAILS	2
C	CENTER DOOR RAIL	1
D	DOOR PANELS	14
D1	DOOR PANELS (included with 42" door only)	4
E	SIDE FINISHING STRIPS for Stile	2
F1	SCREW SLEEVES for Top Door Rail	5 (includes 1 extra)
F2	SCREW SLEEVES for Center and Bottom Rails	7 (includes 1 extra)
G	U CLIP BRACKETS	2
J	SCREWS AND WASHERS for Door Assembly	12 (includes 2 extra)
K1	OPTIONAL K Top Section	2
K2	OPTIONAL K Bottom Section	2
L1	OVAL WASHERS for Center Rail Install	2
L2	OVAL WASHERS for Top/Bottom Rail Install	4
O	ROLLER BRACKETS	2
P	HANDLE (includes handle, bolts, washers, nuts, wrenches)	1
Q	SCREWS to attach U Clip Brackets	10 (includes 6 extra)
R	TRACK (includes anchors for masonry application)	1
R1	TRACK EXTENSION KIT (included with 42" door only)	1 extension kit
S	SPACERS for track install	5
T	DOOR STOPS	2
V	FLOOR GUIDE with screws	1
W	SAFETY SPACERS with screws	2
X	LAG BOLTS for Track Installation	5
Y	ALLEN SCREWS for Roller Brackets	4

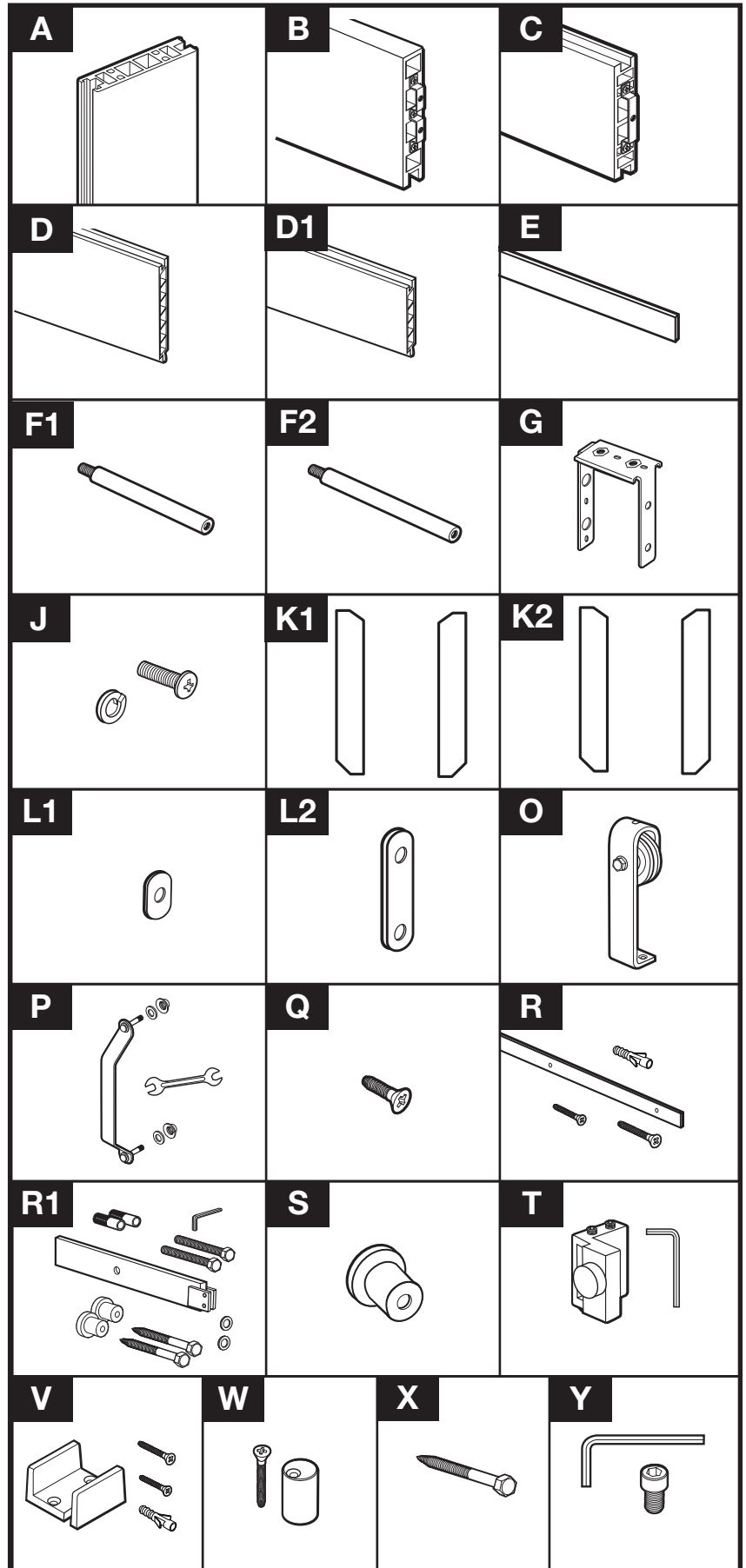

# Montana Overview 36"

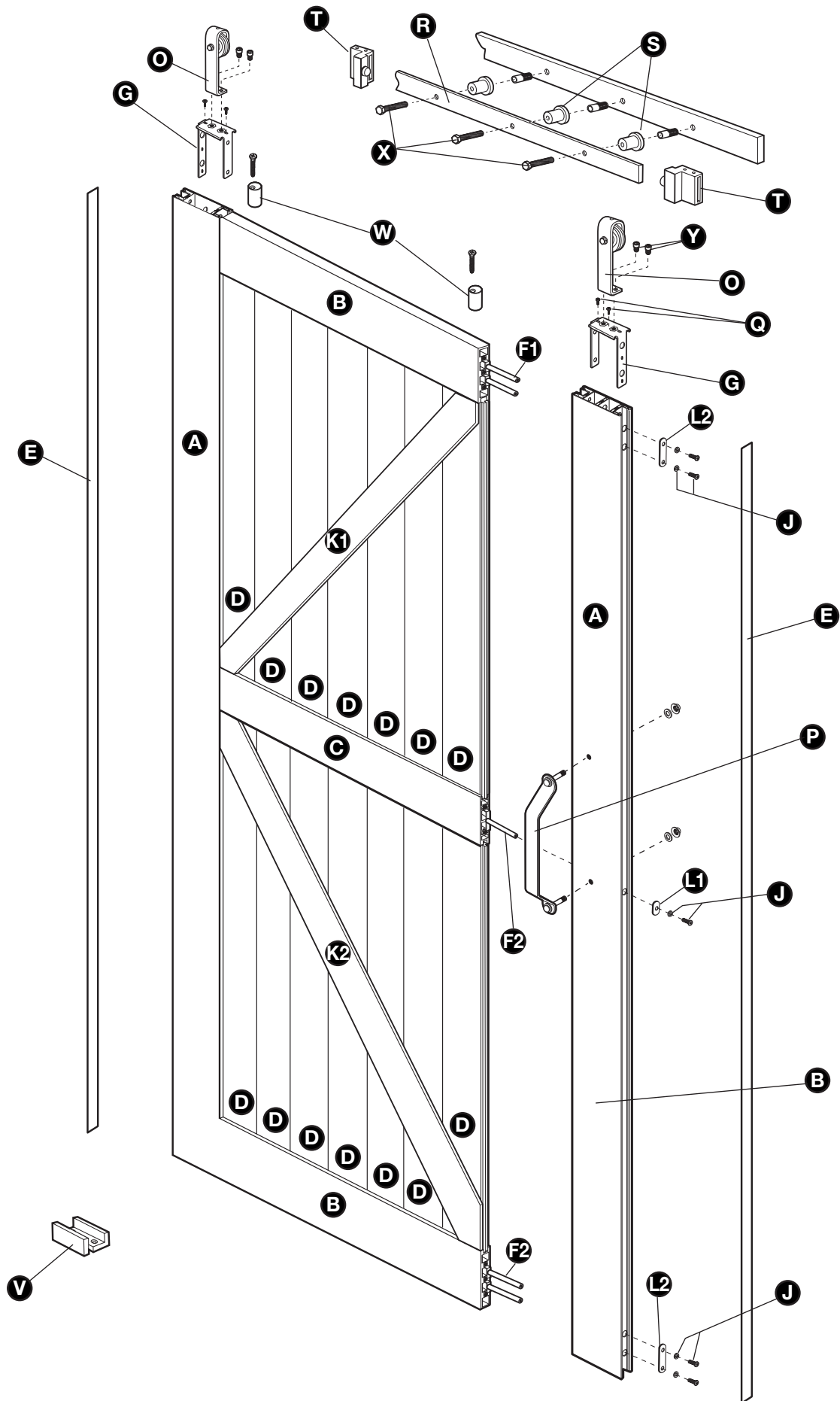

# Montana Overview 42"

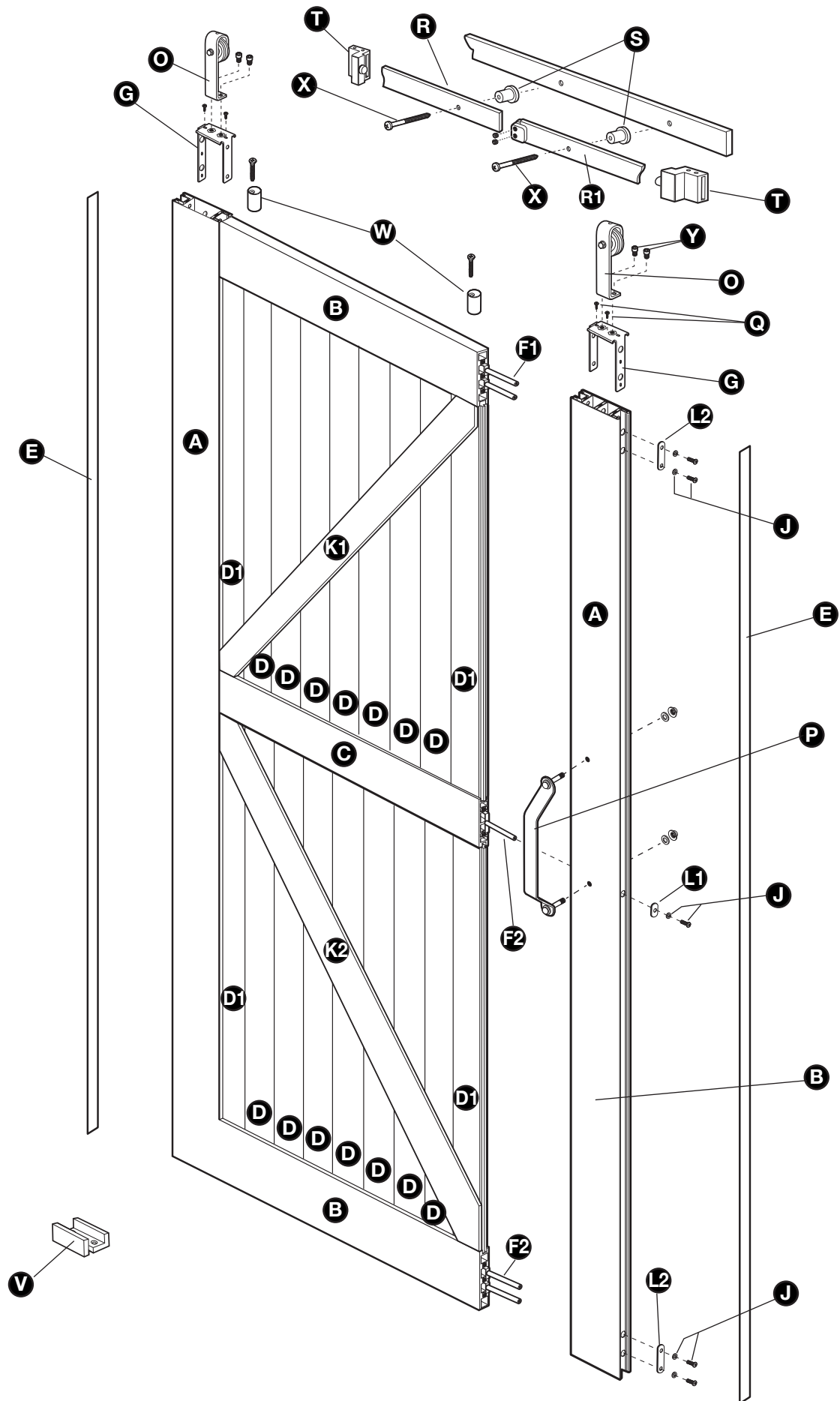

# 42" Barn Door Track Extension Kit

For the 42" Barn door, it is necessary to use the track extension included in your Barn door kit.

## Kit Includes

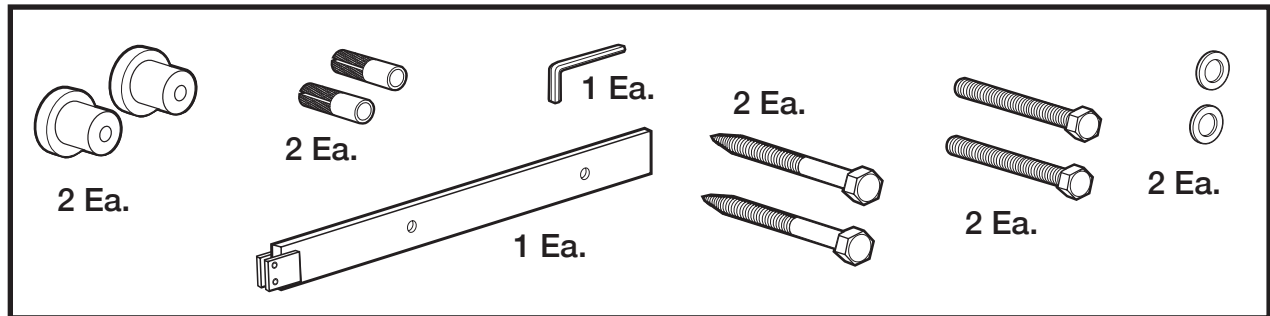

## Tools Needed

Level

To attach the extender, lay the track on the floor. Slip the extender (R1) onto the end of the track where the door will be in the open position. It is important that the side of the track extender with the lip is facing to the top. Begin tightening the 2 screws with the allen wrench (See Figures 1A & 1B). Use the level to be sure the track and extender are straight and then fully tighten (See Figure 2). Turn the track and extender over, use the allen wrench to tighten the 2 remaining screws. Use the level one more time to check the track is straight and then fully tighten the screws.

The extended track is now ready to install. Please refer to the Instructions for your Barn door kit for proper installation.

**IMPORTANT:** It is important to read all instructions before you begin installation. A mounting board is recommended and must be installed prior to hanging the track and door.

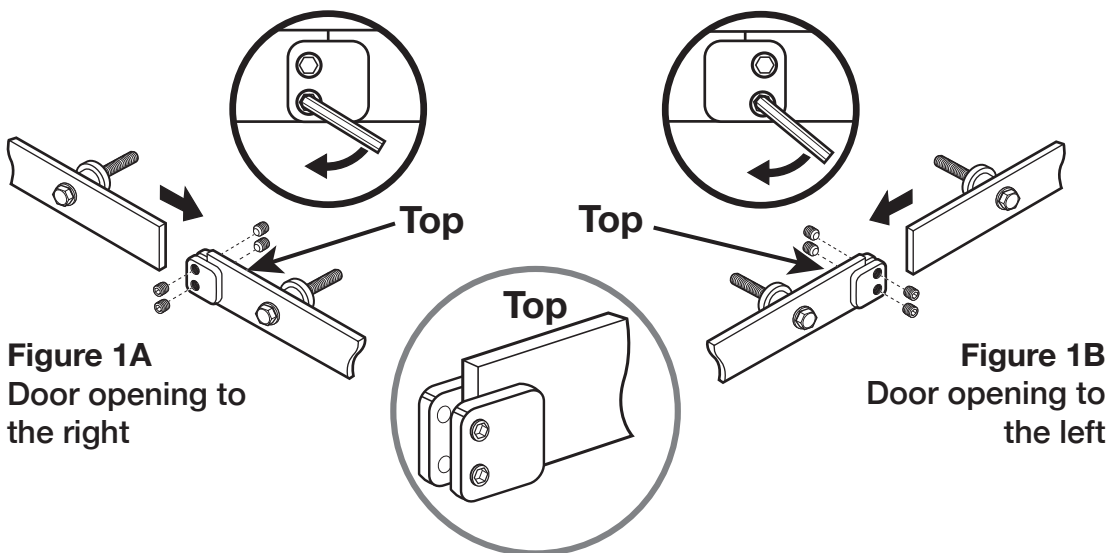

**Figure 1A**  
Door opening to  
the right

**Figure 1B**  
Door opening to  
the left

**Figure 2**

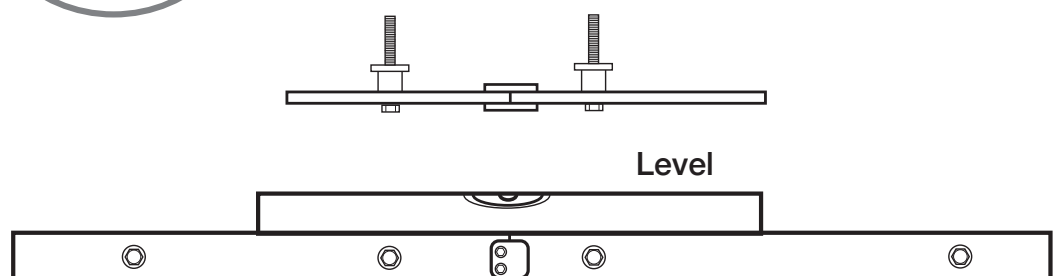

# Montana Door Assembly and Track Installation

**Please read ALL instructions before you begin installation.**

You MUST determine if you need a Mounting Board prior to doing ANY installation. Due to many overlapping factors such as the location of wall studs, the weight of a Barn door and the various types of trim used in homes, we recommend using a Mounting Board in all situations. Track must be installed into Solid Blocking or Head Casing.

## Tools Needed

You will need a Pencil, Phillips head screwdriver, Tape measure, Drill, Assorted Drill bits (5/16" & 3/8"), 1/2" socket ratchet, 4ft Level, Rubber mallet and Safety glasses.

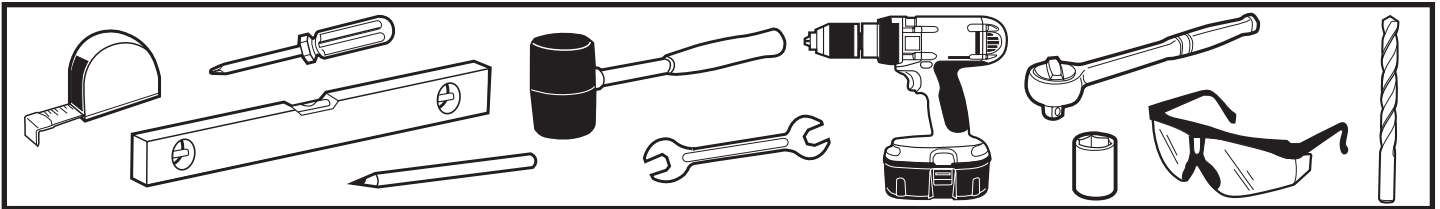

**NOTE**

### NOTE:

It is very important to determine whether you will be installing a Mounting Board prior to installing the track. If you do need to install a Mounting Board, it **MUST** be installed first. (Mounting Board Not Included)

**NOTE**

## 1. Attach Screw Sleeves to Rails

Take the Top Rail (B) and attach the 4 Top screw sleeves (F1) to the metal brackets. Hand-tighten only. Do not over-tighten. Take the Center rail (C) and Bottom rail (B) and attach the 6 Center/Bottom screw sleeves (F2) to the metal brackets. Again, Hand-tighten only. Do not over-tighten. Set the Rails aside.

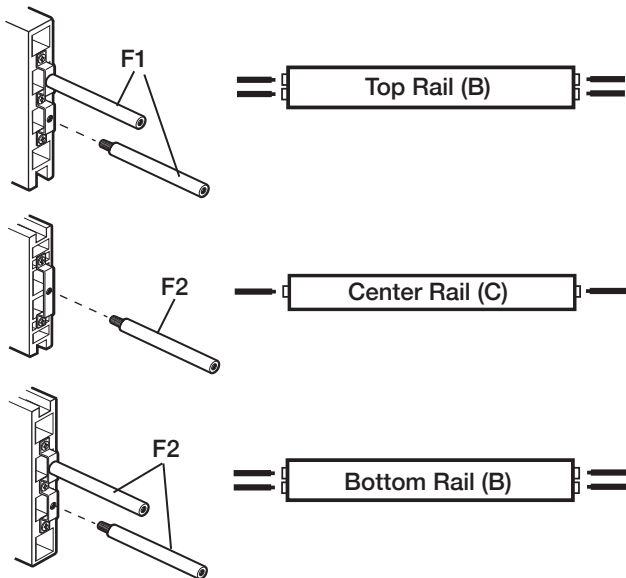

## 2. Remove Finishing Strips

Take the 2 Door Stiles (A) and remove the finishing strips (E) from the outer stile channels. Set the strips aside.

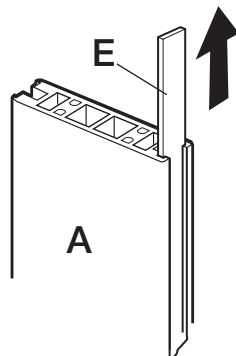

## 3. Attach U Clips to Door Stiles

Make sure the wider channel in the stile with the larger holes is facing to the outside. Make sure the larger holes in the U clip are facing to the inside of the stile and insert the U clip (G) into the end of a Stile (A). The top of the U clip will rest on the top of the Stile once inserted. Take 2 of the U clip screws (Q) and using the Phillips head screwdriver, secure the U clip to the Stile. Hand-tighten only and do not over tighten. Repeat with the other Stile, U Clip and screws.

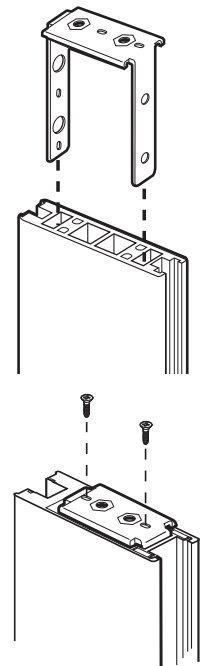

## 4. Attach Roller brackets

Take one of the Roller brackets (O) and 2 of the Allen screws (Y) and secure to the U clip (G) with the Allen wrench. Repeat with the other Roller Bracket.

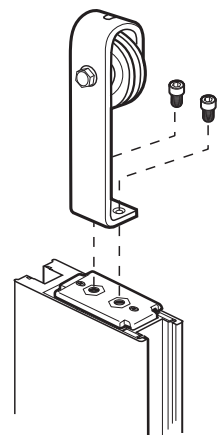

# Montana Door Assembly and Track Installation

## 5. Attach Top Rail to Stile

Take one of the Top/Bottom Rails (B) making sure the closed edge is facing up towards the top of the door and insert the attached screw sleeves (F1) through the pre-drilled holes in the inside edge of the door stile (A).

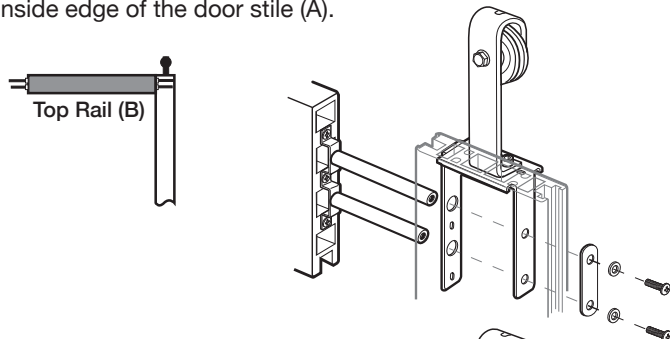

Place the oval washer (L2) over the 2 pre-drilled holes in the outer channel of the stile and using the screwdriver, secure with 2 of the screws with locking washers (J). Hand-tighten only.

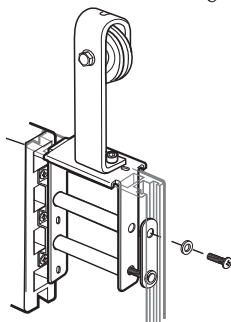

## 6. Attach Center Rail to Stile

Take the Center Rail (C) and insert the attached screw sleeve (F2) through the pre-drilled hole in the inside edge of the door stile (A). Place the oval washer (L1) over the pre-drilled hole in the outer channel of the stile and using the screwdriver, secure with 1 of the screws with locking washers (J). Hand-tighten only.

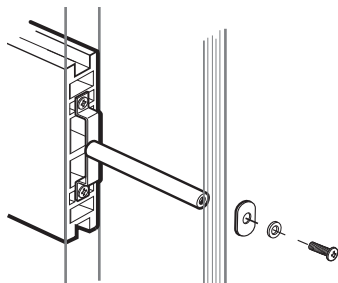
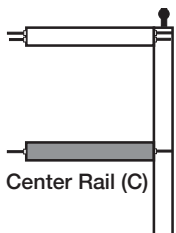

## 7. Attach Bottom Rail to Stile

Take one of the Top/Bottom Rails (B) making sure the closed edge is facing towards the bottom of the door and insert the attached screw sleeves (F2) through the pre-drilled holes in the inside edge of the door stile (A). Place the oval washer (L2) over the 2 pre-drilled holes in the outer channel of the stile and using the screwdriver, secure with 2 of the screws with locking washers (J). Hand-tighten only.

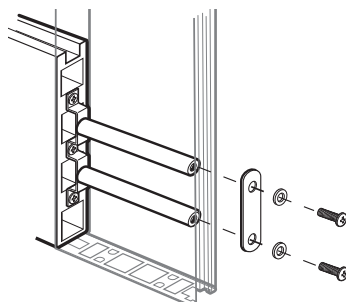
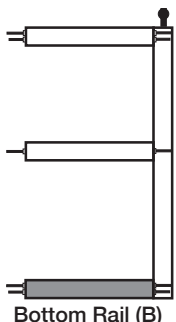

## 8. Insert Door Panels

### For 42" Door

Take one of the (D1) door panels and insert into the Top section of the door. Tap into place with a rubber mallet. Then insert 7 (D) door panels into the Top section. Tap each into place with the rubber mallet as you go. Be sure they are snug and secure. For the last panel in the top section, insert another (D1) panel and tap into place. Repeat these steps for the Bottom section of the door. There will be 9 total panels in the top and 9 total panels in the bottom.

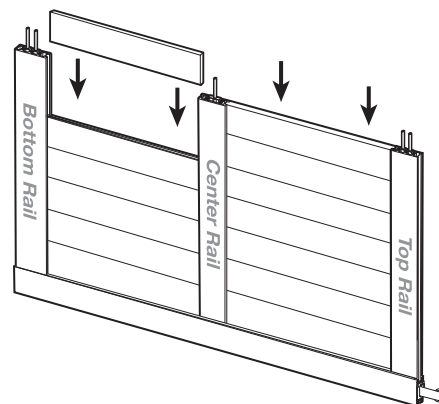

### For 36" Door

Take one of the (D) door panels and insert into the Top section of the door. Tap into place with a rubber mallet. Then insert the 6 of the (D) door panels into the Top section. Tap each into place with the rubber mallet as you go. Be sure they are snug and secure.

Repeat these steps for the Bottom section of the door. There will be 7 total panels in the top and 7 total panels in the bottom.

## 9. Attach Remaining Stile

Insert all of the Screw sleeves (F1 and F2) through the pre-drilled holes in the inside edge of the door Stile (A). Place an oval washer (L2) over the 2 pre-drilled holes in the outer channel of the stile in the Top rail, and using the screwdriver, secure with 2 of the screws with locking washers (J). Place an oval washer (L1) over the pre-drilled hole in the outer channel of the stile at the Center rail and using the screwdriver, secure with 1 of the screws with locking washers (J). Place an oval washer (L2) over the 2 pre-drilled holes in the outer channel of the stile at the bottom rail, and using the screwdriver, secure with 2 of the screws with locking washers (J). Hand-tighten only.

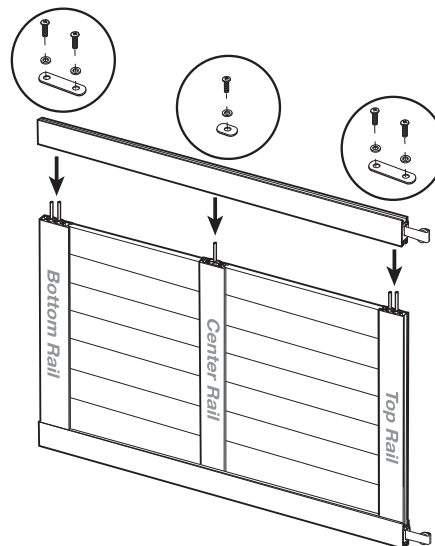

# Montana Door Assembly and Track Installation

## 10. Insert Finishing Strips

Re-insert the 2 finishing strips (E) into the outer channels of the Door Stile.

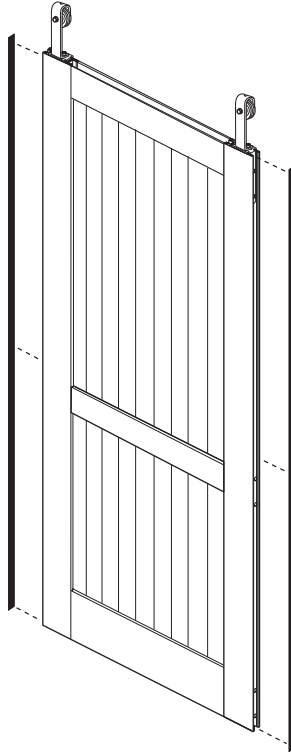

## 11. Install Handle

Measure up 52" from the bottom of the door and mark that location. Measure in 1 3/4" in from the edge of the stile and mark this spot. Drill a hole through the stile at the intersection of these 2 marks. Place the handle (P) on the door and insert one of the handle bolts into the top hole in the handle. Put the washer and nut onto the backside of the door and tighten the nut. Do not tighten fully at this point. Using a level to make sure the handle is plumb, mark the location of the bottom hole in the handle. Move the handle aside and drill the second hole through the stile. Put the remaining bolt through the hole in the handle. Put the washer and nut onto the backside of the door and tighten the nut. Use the wrenches provided to fully tighten the bolts and secure the handle.

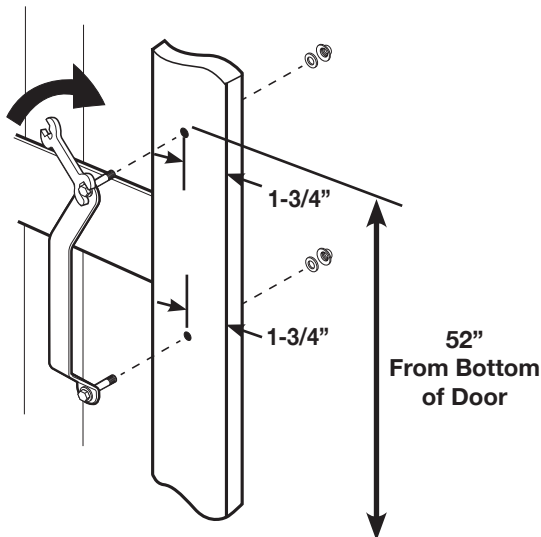

## 12. Install Safety Spacers

The Safety spacers (W) help to protect the door from being bumped off of the track. With the door laying flat in a safe and secure position, place one of the two spacers approximately 2" to the inside of one of the roller brackets. Place slightly off center towards the front of the door. Using a drill, secure the spacer with the screw provided. Repeat steps to install the second spacer inside the other roller bracket.

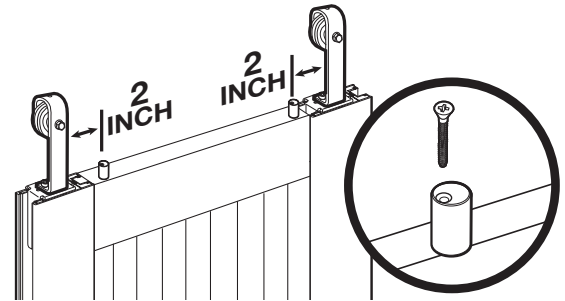

## 13. Install Optional K

To install the Optional K, take one of the K1 pieces, remove the adhesive strips and press into place in the top section of the door. Take one of the K2 pieces, remove the adhesive strips and press into place in the bottom section of the door. Repeat steps on the other side of the door. **\*Please note: Adhesive is strong so the K will stay in place. Please be sure you would like the K design before attaching it.**

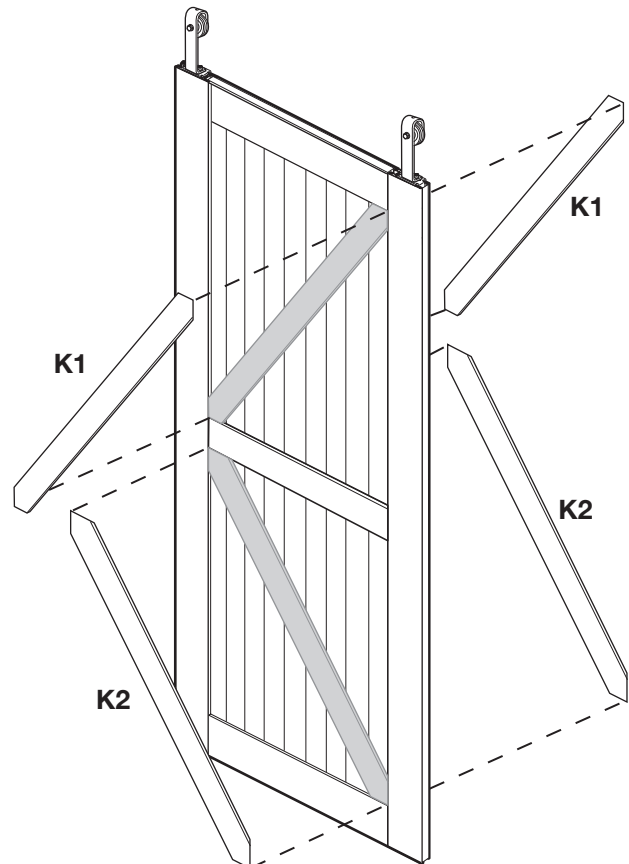



# Montana Door Assembly and Track Installation

## 14. Measure Height for Track

In order to determine the proper Height for your Barn Door Track, add 3" to the height of the door being installed. Locate and mark this height on the wall (or mounting board) on the side of the doorjamb where the door would be in the closed position.

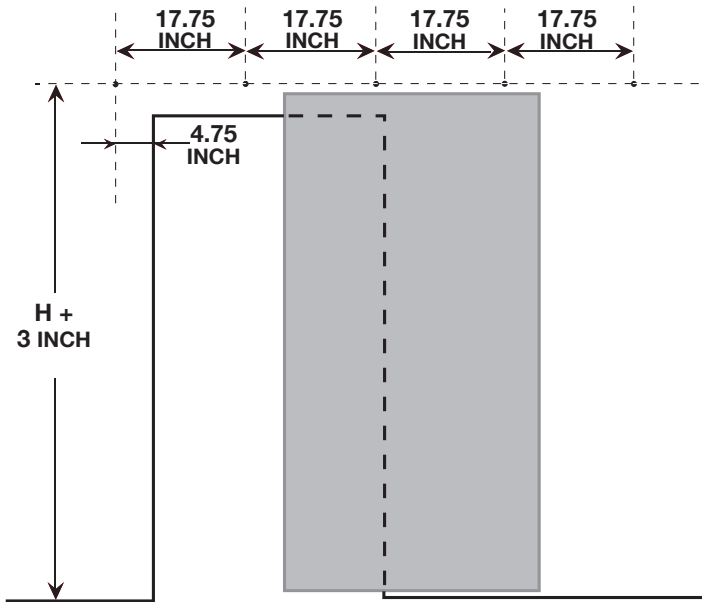

## 15. Determine Track Location

On the same side where you made your Height mark, measure 4-3/4" over from the doorjamb and draw a line so the 2 measurements intersect. This will be the location of the first hole in the Track.

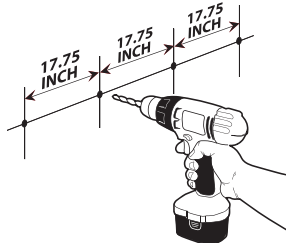

## 16. Insert Mounting Hardware/Track

Drill pilot hole. Insert lag bolt (X) through the first track hole, then place the track spacer (S) through the bolt on back of the track. Install the lag bolt with 1/2" socket ratchet. Do not tighten fully. Swing the track up and use the level to ensure the track is straight. Mark the remaining holes in the track. Drill the remaining pilot holes. Slide a stopper (T) onto the track for the end of the track where you installed the first bolt, so it is between the first and second holes on that end of the track. Make sure the rubber pieces on the stoppers are facing to the inside for both stoppers. Install the next bolt and spacer at this end of the track. Install the remaining bolts and spacers. Go back and fully tighten the first bolt. Slide the remaining stopper onto the other end of the track. Do not set either stopper at this point.

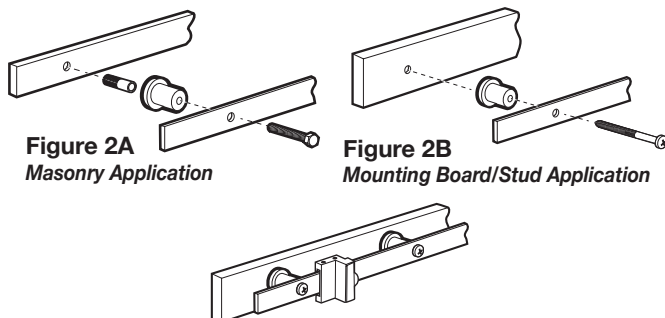

## 17. Place Door onto Track

Position the door over the opening and slightly tilt the bottom of the door outward away from the wall. Set the rollers securely onto the track. Once the door is safely mounted and is secure, turn the 2 safety spacers 180 degrees towards the wall. This positions them properly under the track.

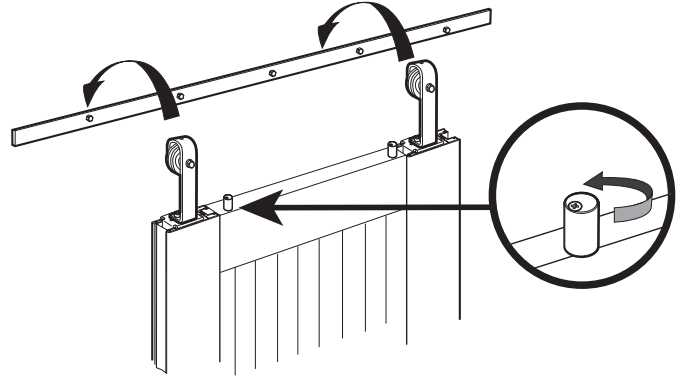

## 18. Install Floor Guide

The Bottom Door guide (V) keeps the door from swinging outward away from the wall. To locate the proper installation position in the floor, slide the door into the closed position and mark the outside edge of the door on the floor. Now place the door into the open position and mark the inside edge of the door on the floor. Make sure your guide location is well marked. Make sure that whether the door is in the open or closed position that the door NEVER leaves the Door guide. This is the proper location for the Door guide. Set the width of the floor guide to 1-1/2". Slide the door out of the way and place the guide on the floor in between the 2 marks. Pre-drill holes if necessary for your floor type. Using a drill and the screws provided, secure the Door guide to the floor. .

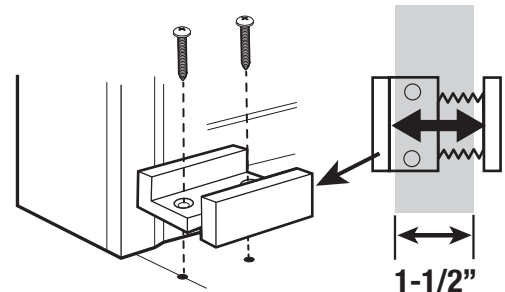

## 19. Set Door Stops on Track

Move the door to the closed position and slide the Door stop to desired location. Using the provided Allen wrench, tighten the screws in the door stop to secure it into place. Then carefully glide the door into the fully open position and repeat the steps for the remaining Door stop.

