

# INSTALLATION OF PVC DOUBLE BARN DOOR CENTER OPENING STYLE

Please read ALL instructions before you begin installation.

You MUST determine if you need a Mounting Board prior to doing ANY installation. Due to many overlapping factors such as the location of wall studs, the weight of a Barn door and the various types of trim used in homes, we recommend using a Mounting Board in all situations (Mounting Board Not Included). Track must be installed into Solid Blocking or Head Casing.

## Tools Needed:

You will need a Pencil, Phillips head screwdriver, Tape measure, Drill, Assorted Drill bits (5/16" & 3/8"), 1/2" socket ratchet, 4ft Level, Safety glasses and Step ladder.

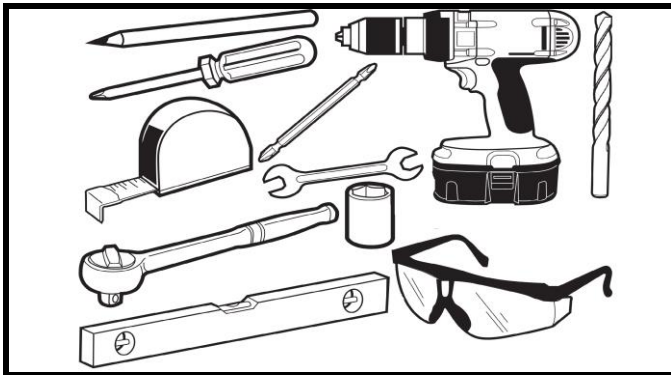

## Parts List:

Make sure ALL parts are included before beginning.

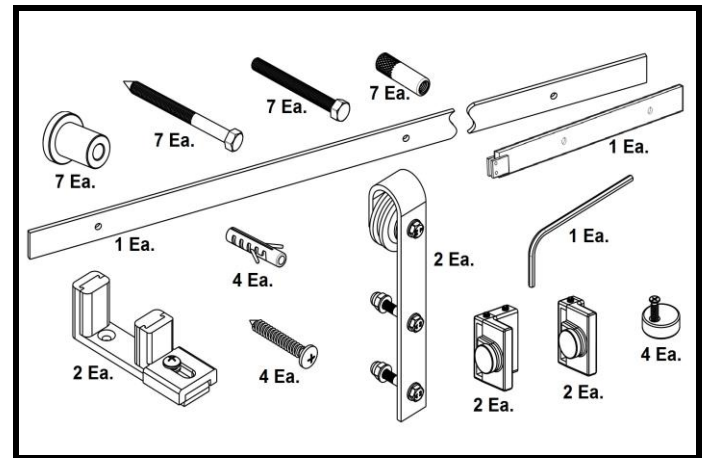

## NOTE:

**NOTE**

It is very important to determine whether you will be installing a Mounting Board prior to installing the track. If you do need to install a Mounting Board, it MUST be installed first.

**NOTE**

The Mounting Board must be 1x6" (Thickness x Width) at least. The length of the header should be the length of the Barn door track, or slightly longer. The barn door track should be mounted along the center; therefore, avoid placing the screws along the center of the header. Header screws should be across the top and bottom of header (2 per stud). The holes for the barn door track must be 85-7/8" from the floor; therefore, the center line of the Mounting Board MUST be at 85-7/8" above from the floor.

## STEP 1: Attach the extender

To attach the extender, lay the track on the floor. Slip the extender onto one end of the track. It is important that the side of the track extender with the lip is facing to the top. Begin tightening the 2 screws with the allen wrench. Use the level to be sure the track and extender are straight and then fully tighten. Turn the track and extender over, use the allen wrench to tighten the 2 remaining screws. Use the level one more time to check the track is straight and then fully tighten the screws.

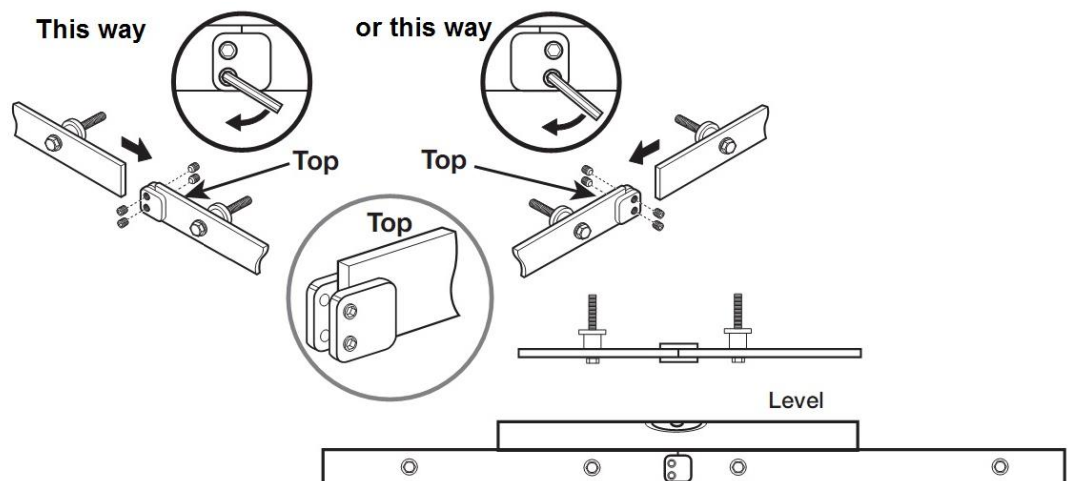

## STEP 2: Insert the center stopper

Mark the center of the Barn door track. This should be at 48.25" from the end of the track. Slide both of the center stoppers

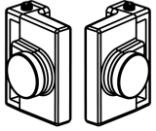

onto opposite end of the track where you attached the extender and push them to the center mark. For the center stoppers, the rubber stoppers should be facing away from each other (see diagram). Once on the center mark, secure them into place using the allen wrench provided.

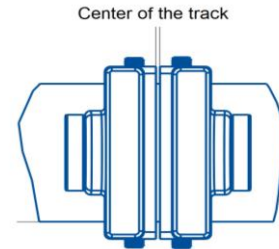
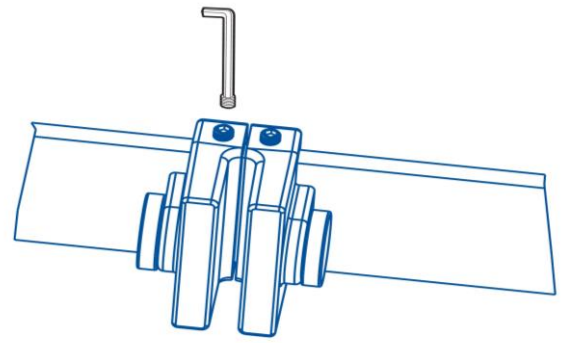

## STEP 3: Determine Track Location

Measure the width of the door opening. Find the center of the opening and place a mark  $85\text{-}7/8"$  above the floor. This will be the position of the center of the track (and the center stoppers).

Have an assistant help hold the track so the center of the track (the center stoppers) are over the center mark you made above. Level the rail with the 4' level. Mark all seven holes. Drill pilot holes. All the holes must be into Solid Blocking or Head Casing or Mounting Board

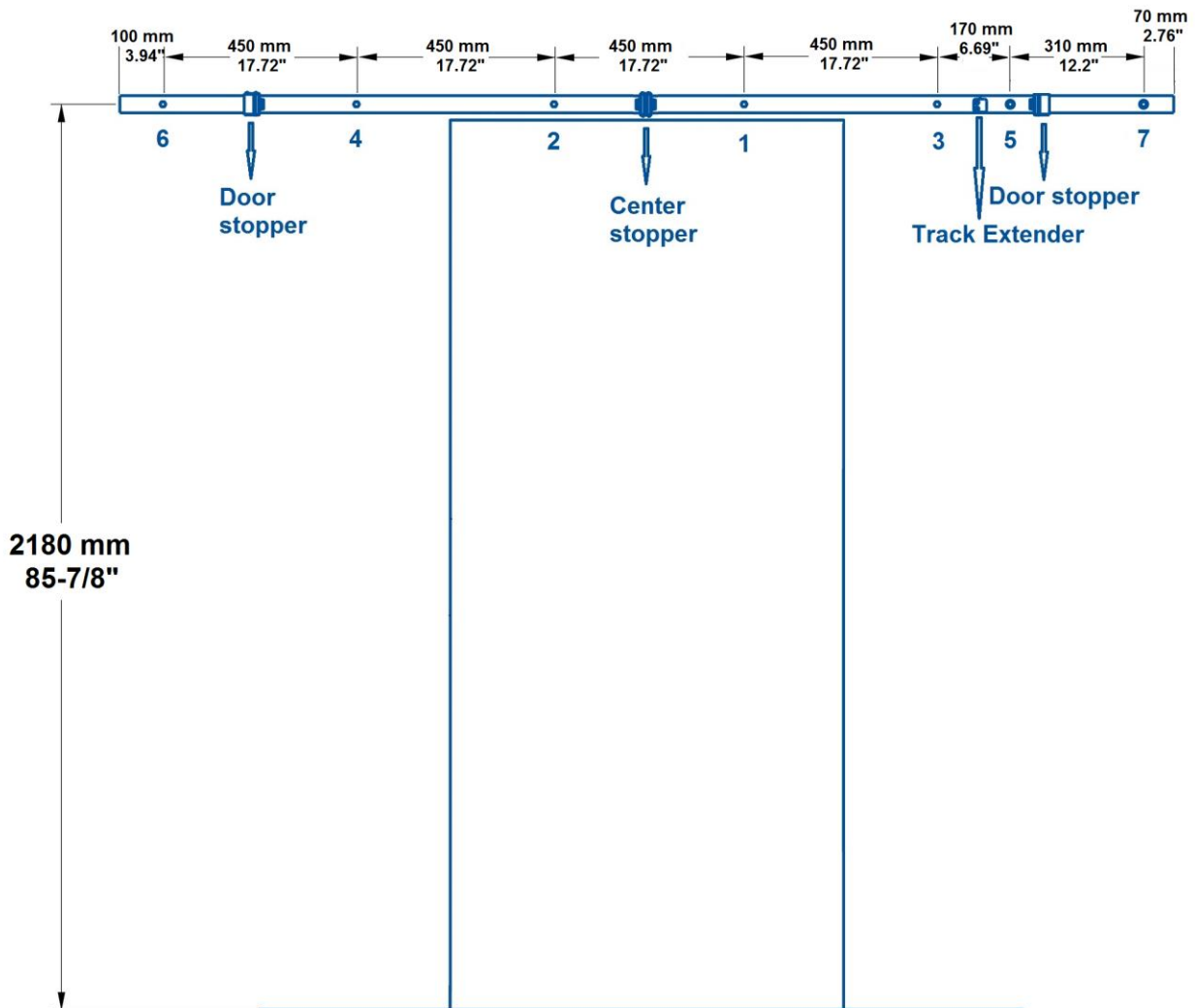

#### STEP 4: Insert 5 of the Lag bolts (Do not insert into 2 outermost track holes at this point)

Insert a lag bolt through the each hole, then place the track spacer through the bolt on back of the track. Install the lag bolt with ½" socket ratchet but do not tighten fully. Do each hole from the center hole to the hole near the end. Do for the Hole#1, after that do the same with Hole# 2 and Hole# 3,4,5. Each time check to level the track. Leaving Hole#6 and 7 for later. Refer the Diagram at **STEP 3**

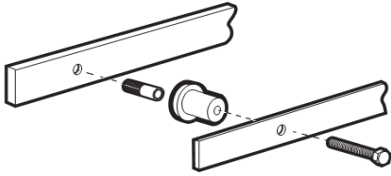

*Masonry Application*

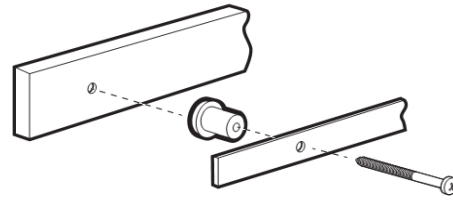

*Mounting Board/Stud Application*

#### STEP 5: Insert the Outer door stoppers and last 2 bolts

From one end of the track, slide a stopper onto the track so it is past hole 6 in the track. Make sure the rubber stopper is facing inward (see diagram). Install the bolt and spacer for hole 6. Repeat steps on the other end for hole 7. Go back and fully tighten all bolts.

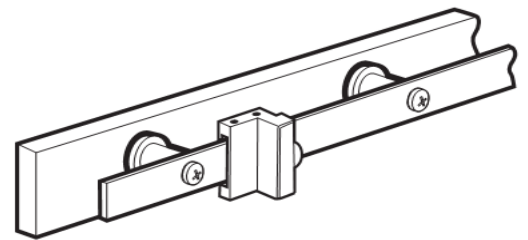

#### STEP 6: Install Bracket Rollers

Each door stile is with two pre-drilled holes at top for attaching Roller brackets on it. Place the bracket over pre-drilled holes and make sure bracket is plumb. Using the socket wrench or an adjustable wrench to tighten the bracket bolts. Repeat with the other bracket for this door and then install the roller brackets onto the remaining doors. Note: The door handles will be on the inner stile of each door for a center opening door..

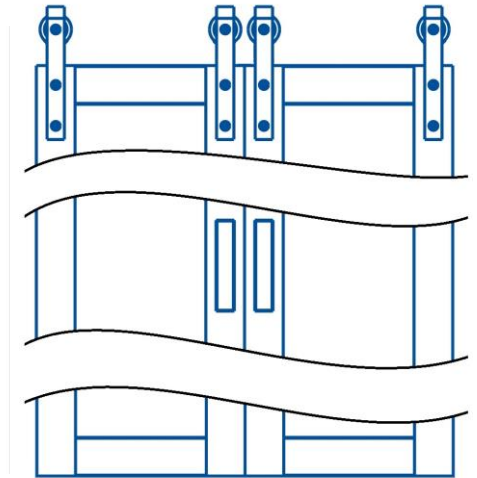
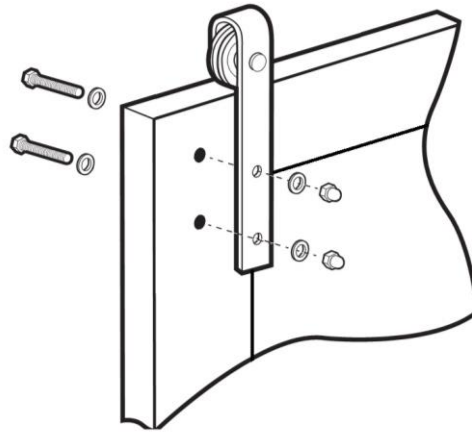

#### STEP 7: Install Safety Spacers

Once the Roller have been secure, it is important to install the Safety spacers. These spacers help to protect the door from being bumped off of the track. With the door laying flat in a safe and secure position, place one of the two spacers approximately 1.5" to the inside of one of the roller brackets. Place slightly off center towards the front of the door. Using a drill, secure the spacer with the screw provided. Repeat the step to install the second spacer inside the other roller bracket. Repeat the step with the other door.

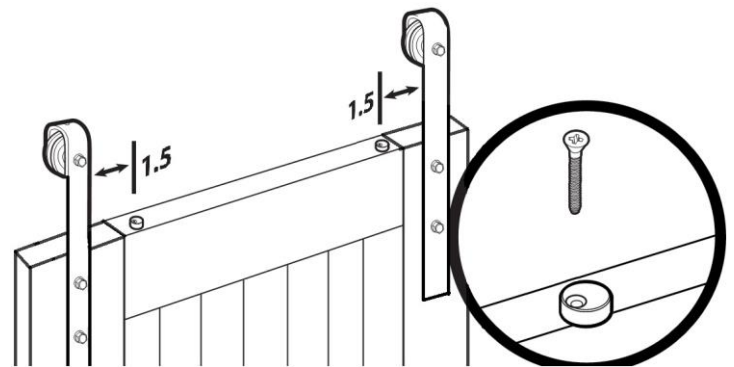

### STEP 8: Place door onto Track

Position the door over the opening and slightly tilt the bottom of the door outward away from the wall. Set the rollers securely onto the track. Once the door is safely mounted and is secure, turn the 2 safety spacers 180 degrees towards the wall. This positions them properly under the track. Repeat the step with the other door. NOTE: please make sure when hanging the doors that the door handles should be on the inner stile of each door for a center opening door (refer to door diagram on final page).

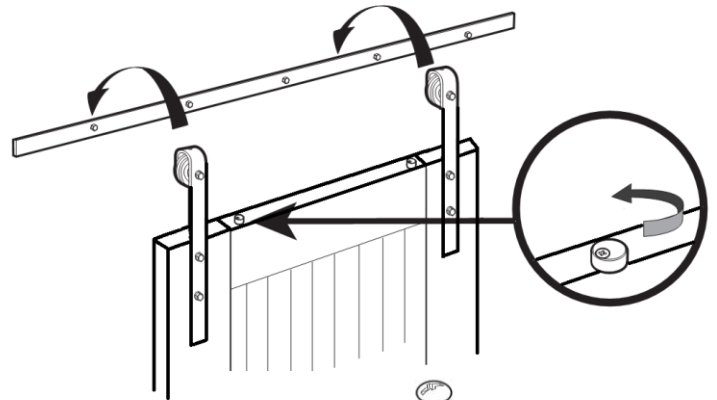

### STEP 9: Secure Floor Guide

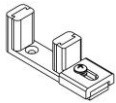

The Floor Guide keeps the door from swinging outward away from the wall. To locate the proper installation position in the floor, slide the door into the closed position. Take the floor guide and remove the screw and washer. Set them aside with the top piece of the guide. Take the bottom piece of the guide and place it on the floor under the outer edge of the door about  $\frac{1}{2}$ " in from the edge of the door. The back of the guide will sit between the wall and the back of the door but should not touch the door. Mark the front hole location in the guide. Move the door to the open position to make sure the guide is in the proper position. Whether the door is in the open or closed position, the door should NEVER leave the Door guide. Once you have the proper position for the guide, move the door out of the way and install the first screw into the guide. Make sure the guide is straight and install the second screw in the guide. Re-insert the top piece of the guide with the screw and washer setting the width of the floor guide to  $1\frac{1}{2}$ ". Pre-drill holes if necessary for your floor type. Using a drill and the screws provided, secure the Floor Guide to the floor. Repeat the step with the other door.

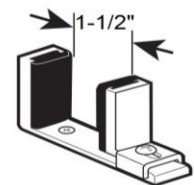
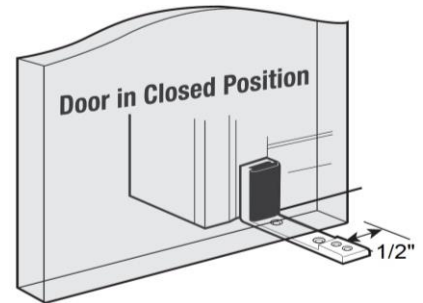
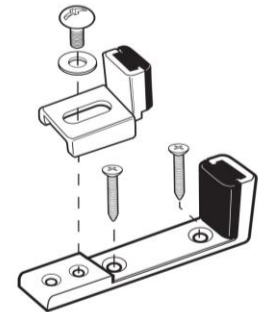

### STEP 10: Set Door Stoppers on Track

Carefully glide one of the doors to the fully open position and slide the outer stopper to that location. Using the allen wrench provided, tighten the screws in the stopper to secure it into place. Repeat the steps for the remaining outer door stopper.

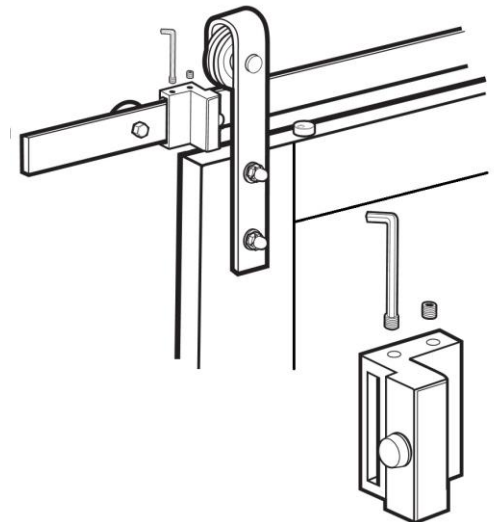

# OVERVIEW

